

# RÜCKSCHLAGKLAPPE

TYPE 5/500

# SWING CHECK VALVE

PN16-250

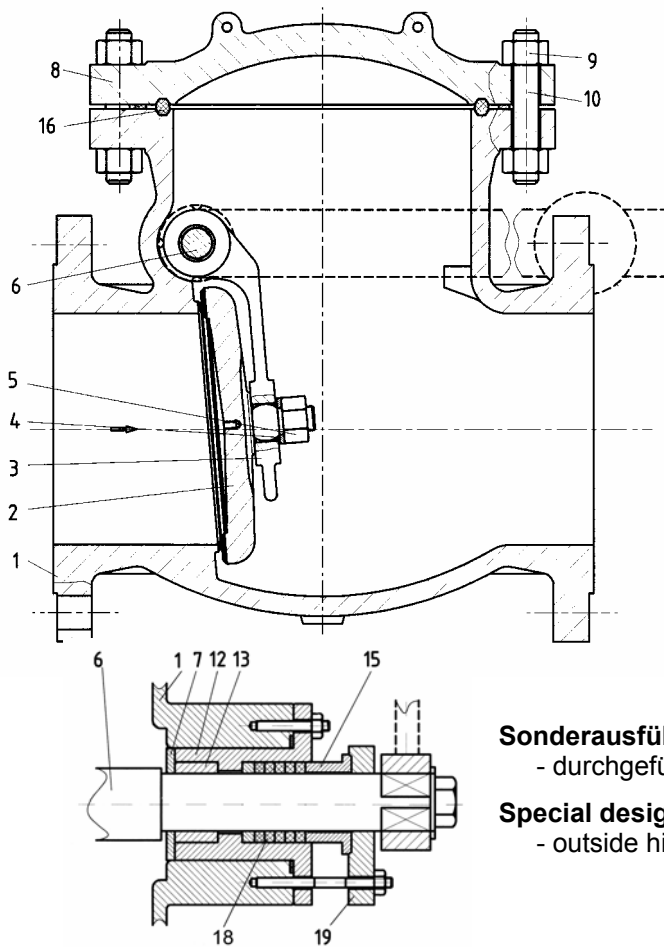

**Ausführung:**

- Baulängen nach DIN3202 und EN558-1.

**Anwendung:**

- für flüssige und gasförmige Medien.  
- Einsatzgrenzen nach DIN2401.

**Anschluss:**

- Flanschen nach DIN2501.  
- Schweißenden nach DIN3239-T1.

**Design:**

- face to face dimension acc. DIN3202 and EN558-1.

**Application:**

- for liquid and gaseous media  
- pressure-temperature rating acc. DIN2401.

**Connection:**

- flanges acc. DIN2501  
- butt welding ends DIN3239-T1.

**Sonderausführung:**

- durchgeführte Klappenwelle mit Hebel und Gewicht

**Special design:**

- outside hinge pin with lever and counter-weight

Werkstoffe / Materials

| Pos. | Benennung        | Designation       | Option / option   |                   |                   |
|------|------------------|-------------------|-------------------|-------------------|-------------------|
|      |                  |                   | standard          | -30°C ÷ 550°C     | -45°C ÷ 345°C     |
| 1    | Gehäuse          | body              | GP240GH           | G17CrMo9-10       | G18Mo5            |
| 2    | Klappenscheibe   | disc              | GP240GH           | G17CrMo9-10       | G18Mo5            |
| 3    | Hebel            | hinge             | GP240GH           | G17CrMo9-10       | G18Mo5            |
| 4    | Distanzstück     | spacer            | St37 – 3N         | 10CrMo9-10        | 15Mo3             |
| 5    | Klappenmutter    | disc nut          | Ck25              | 24CrMoV-55        | 24CrMo5           |
| 6    | Klappenwelle     | hinge pin         | X10Cr13           | X10CrNiMoTi18.9   | X10CrNiTi18.9     |
| 8    | Deckel           | bonnet            | GP240GH           | G17CrMo9-10       | G18Mo5            |
| 9    | Schraube         | stud              | 42CrMo4           | 24CrMoV-55        | 42CrMo4           |
| 10   | Mutter           | nut               | Ck45              | 24CrMoV-55        | 24CrMo5           |
| 12   | Buchse           | bushing           | Ck25              | 10CrMo9-10        | 15Mo3             |
| 13   | Lagerbuchse      | bearing bushing   | A439-D2c          | A439-D2c          | A439-D2c          |
| 15   | Stopfbuchse      | gland             | 15Mo3             | 10CrMo9-10        | 15Mo3             |
| 16   | Dichtung         | gasket            | Stahl / steel     | Stahl / steel     | Stahl / steel     |
| 18   | Packung          | packing           | Grafit / graphite | Grafit / graphite | Grafit / graphite |
| 19   | Stopfbuchsbrille | gland flange      | Ck25              | Ck25              | Ck25              |
| 22   | Gewichtshebel    | lever with weight | Stahl / steel     | Stahl / steel     | Stahl / steel     |



# RÜCKSCHLAGKLAPPE

TYPE 5/500

# SWING CHECK VALVE

PN16-250

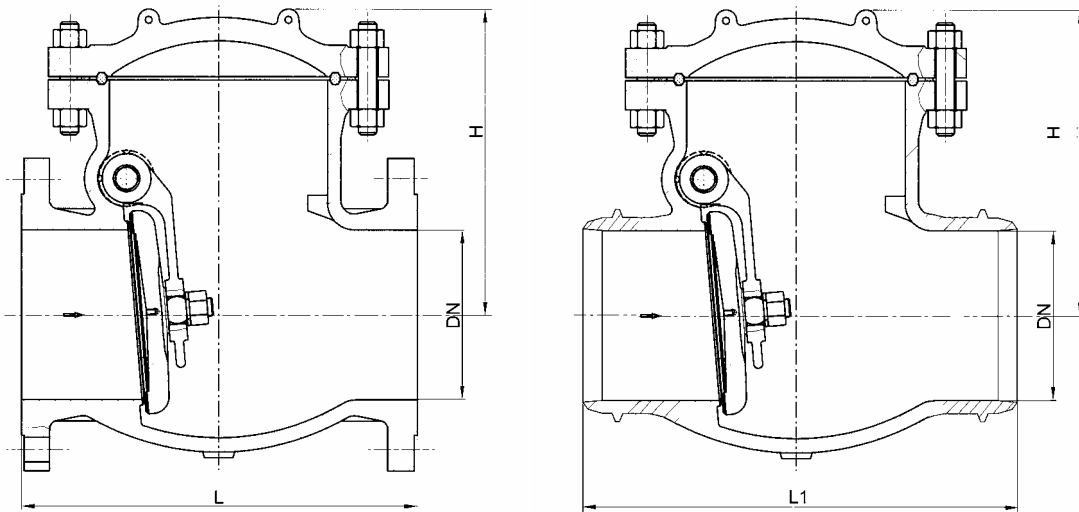

Abmessungen / Dimensions

| DN   | PN16 |      |      | PN25   |      |      | PN40   |      |      | PN63 |      |      |       |
|------|------|------|------|--------|------|------|--------|------|------|------|------|------|-------|
|      | L/L1 | H    | kg   | L / L1 | H    | kg   | L / L1 | H    | kg   | L    | L1   | H    | kg    |
| 40   | 180  | 125  | 9    | 200    | 130  | 15   | 200    | 130  | 20   | 260  | 210  | 150  | 30    |
| 50   | 200  | 135  | 24   | 230    | 140  | 28   | 230    | 140  | 32   | 300  | 250  | 160  | 35    |
| 65   | 240  | 165  | 31   | 290    | 170  | 37   | 290    | 170  | 43   | 340  | 340  | 190  | 49    |
| 80   | 260  | 175  | 36   | 310    | 180  | 45   | 310    | 180  | 54   | 380  | 380  | 200  | 64    |
| 100  | 300  | 190  | 53   | 350    | 195  | 72   | 350    | 195  | 90   | 430  | 430  | 215  | 108   |
| 125  | 350  | 225  | 65   | 400    | 230  | 100  | 400    | 230  | 136  | 500  | 500  | 250  | 171   |
| 150  | 400  | 240  | 93   | 480    | 245  | 142  | 480    | 245  | 191  | 550  | 550  | 265  | 240   |
| 200  | 500  | 370  | 157  | 600    | 375  | 232  | 600    | 375  | 306  | 650  | 650  | 395  | 380   |
| 250  | 600  | 405  | 237  | 730    | 410  | 358  | 730    | 410  | 479  | 775  | 775  | 430  | 605   |
| 300  | 700  | 465  | 375  | 850    | 470  | 522  | 850    | 470  | 668  | 900  | 900  | 490  | 818   |
| 350  | 800  | 505  | 505  | 980    | 510  | 666  | 980    | 510  | 826  | 1025 | 1025 | 530  | 989   |
| 400  | 900  | 520  | 653  | 1100   | 525  | 869  | 1100   | 525  | 1085 | 1150 | 1150 | 545  | 1302  |
| 450  | 1000 | 635  | 842  | 1200   | 640  | 1129 | 1200   | 640  | 1415 | 1275 | 1275 | 660  | 1705  |
| 500  | 1100 | 670  | 905  | 1250   | 675  | 1185 | 1250   | 675  | 1735 | 1400 | 1400 | 695  | 1885  |
| 600  | 1300 | 755  | 1340 | 1450   | 760  | 1756 | 1450   | 760  | 2173 | 1650 | 1650 | 780  | 2695  |
| 700  | 1500 | 815  | 2290 | 1650   | 820  | 2756 | 1650   | 820  | 3222 | 1800 | 1800 | 840  | 3690  |
| 800  | 1700 | 945  | 2885 | 1850   | 950  | 4168 | 1850   | 950  | 5451 | 2050 | 2050 | 970  | 6740  |
| 900  | 1900 | 1115 | 3335 | 2050   | 1120 | 5218 | 2050   | 1120 | 7100 | 2250 | 2250 | 1140 | 8950  |
| 1000 | 2100 | 1295 | 6180 | 2250   | 1300 | 7696 | 2250   | 1300 | 9213 | 2450 | 2450 | 1320 | 10600 |

| DN  | PN100 |      |     |      | PN160 |     |     |      | PN250 |      |     |      |
|-----|-------|------|-----|------|-------|-----|-----|------|-------|------|-----|------|
|     | L     | L1   | H   | kg   | L     | L1  | H   | kg   | L     | L1   | H   | kg   |
| 40  | 260   | 210  | 160 | 32   | 260   | 210 | 190 | 40   | 300   | 210  | 230 | 45   |
| 50  | 300   | 250  | 170 | 38   | 300   | 250 | 200 | 66   | 350   | 250  | 240 | 69   |
| 65  | 340   | 340  | 200 | 54   | 340   | 340 | 230 | 110  | 400   | 400  | 270 | 118  |
| 80  | 380   | 380  | 210 | 71   | 380   | 380 | 240 | 135  | 450   | 450  | 280 | 167  |
| 100 | 430   | 430  | 225 | 117  | 430   | 430 | 255 | 198  | 520   | 520  | 295 | 295  |
| 125 | 500   | 500  | 260 | 190  | 500   | 500 | 290 | 287  | 600   | 600  | 330 | 495  |
| 150 | 550   | 550  | 275 | 276  | 550   | 550 | 305 | 375  | 700   | 700  | 345 | 690  |
| 200 | 650   | 650  | 405 | 420  | 650   | 650 | 435 | 645  | 800   | 800  | 475 | 1110 |
| 250 | 775   | 775  | 440 | 615  | 775   | 775 | 470 | 1145 | 900   | 900  | 510 | 1840 |
| 300 | 900   | 900  | 500 | 905  | 900   | 900 | 530 | 1445 | 1050  | 1050 | 570 | 2740 |
| 350 | 1025  | 1025 | 540 | 1095 | -     | -   | -   | -    | -     | -    | -   | -    |
| 400 | 1150  | 1150 | 555 | 1435 | -     | -   | -   | -    | -     | -    | -   | -    |
| 450 | 1275  | 1275 | 670 | 1885 | -     | -   | -   | -    | -     | -    | -   | -    |
| 500 | 1400  | 1400 | 705 | 2092 | -     | -   | -   | -    | -     | -    | -   | -    |
| 600 | 1650  | 1650 | 790 | 2980 | -     | -   | -   | -    | -     | -    | -   | -    |
| 700 | 1800  | 1800 | 850 | 4080 | -     | -   | -   | -    | -     | -    | -   | -    |

Technische Änderungen vorbehalten / subject to technical changes without notice

Ausgabe 1-2009 / edition 1-2009 /2.2



A-1234 Wien, POB 63, Akazieng. 36

Tel.: ++43/1/699 96 00-0\* E-Mail: [brunnbauer@brunnbauer.at](mailto:brunnbauer@brunnbauer.at)  
 Fax: ++43/1/699 96 40 Internet: <http://www.brunnbauer.at>

# BRUNNBAUER-ARMATUREN

Produktionsgesellschaft m.b.H.